

# MARTIN AND MARTIN DALES PARISH COUNCIL

## Woodland

The Parish Council voted to plant a Woodland on the old allotments at the top end of North Drove adjacent to the Car Dyke. The Parish Council successfully secured a Forestry Commission Grant to pay for the creation of this Woodland.

The aim is to create a communal Woodland area for use to residents and local people. There will be full public access for walkers and no restrictions on dogs. Approximately 4.8ha will be planted with trees, this is about 5300 trees and 1.2ha of will be open space.

The final agreed plan is shown below:

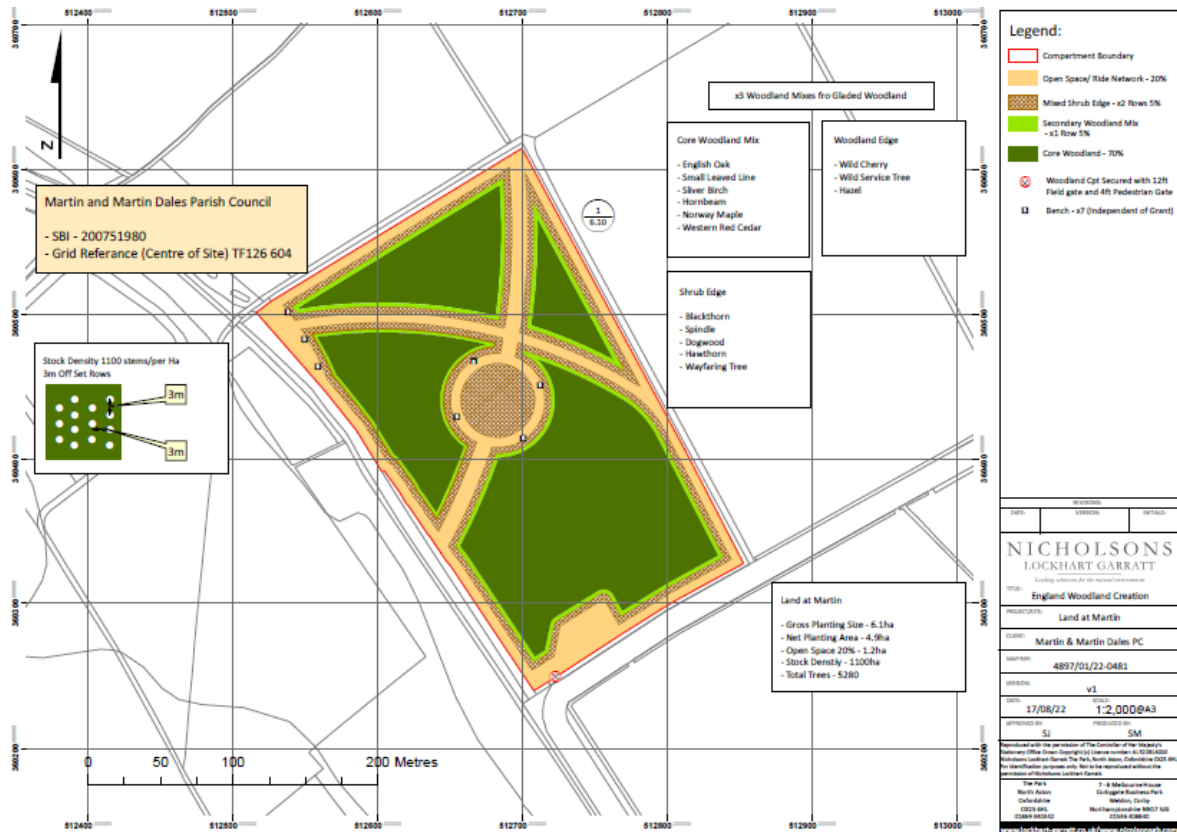

We can save money which can be re invested in the village and/or Woodland, if we plant a percentage of the trees ourselves and it would be fantastic if each household could plant at least one tree, We will be erecting a plaque to state that this wood was created by the residents of Martin Parish.